

# SMD Power Inductor

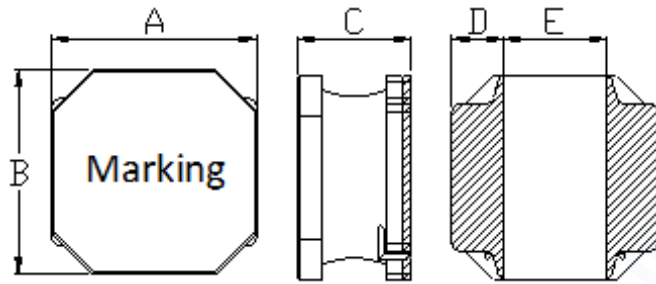

## Dimension (Unit:mm)



A	B	C	D	E
4.0±0.2	4.0±0.2	3.0 Max.	1.0±0.2	2.0±0.3

## Land Pattern (Unit:mm)

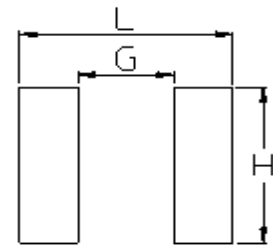

L	G	H
4.1	1.9	3.7

## Specifications 【Inductance Tested at 100kHz, 1Vrms (20 ° c)】

Part Number	Inductance (μH)	Tolerance (±)	DCR (mΩ) ±30%	Isat (A) Max.	Itemp (A) Max.
EPNR4030-1R0N	1.0	30%	15	5.90	3.40
EPNR4030-1R5N	1.5	30%	25	4.85	3.30
EPNR4030-1R8N	1.8	30%	30	4.25	3.20
EPNR4030-2R2M	2.2	20%	35	4.10	2.95
EPNR4030-3R3M	3.3	20%	40	3.30	2.40
EPNR4030-3R6M	3.6	20%	53	3.10	2.30
EPNR4030-3R9M	3.9	20%	57	3.00	2.10
EPNR4030-4R7M	4.7	20%	60	2.90	2.00
EPNR4030-5R6M	5.6	20%	70	2.75	1.95
EPNR4030-6R8M	6.8	20%	75	2.60	1.70
EPNR4030-7R5M	7.5	20%	90	2.20	1.65
EPNR4030-8R2M	8.2	20%	100	2.10	1.60
EPNR4030-100M	10	20%	115	1.95	1.50
EPNR4030-120M	12	20%	140	1.70	1.35
EPNR4030-150M	15	20%	190	1.65	1.15
EPNR4030-180M	18	20%	215	1.40	1.10
EPNR4030-220M	22	20%	225	1.30	1.00
EPNR4030-330M	33	20%	330	1.10	0.84
EPNR4030-470M	47	20%	500	0.90	0.72
EPNR4030-560M	56	20%	560	0.85	0.65
EPNR4030-680M	68	20%	750	0.75	0.55
EPNR4030-820M	82	20%	950	0.68	0.50
EPNR4030-101M	100	20%	1150	0.60	0.45
EPNR4030-151M	150	20%	2350	0.50	0.35
EPNR4030-181M	180	20%	2500	0.40	0.35
EPNR4030-221M	220	20%	3000	0.40	0.30
EPNR4030-331M	330	20%	4400	0.30	0.23
EPNR4030-471M	470	20%	5500	0.30	0.20